

MELS

MELS 1 — STAGE A

90' x 100' x 38'10" High (Grids)
(9,000 sq ft/836 m²)
Cyc 72' x 83' x 24' High

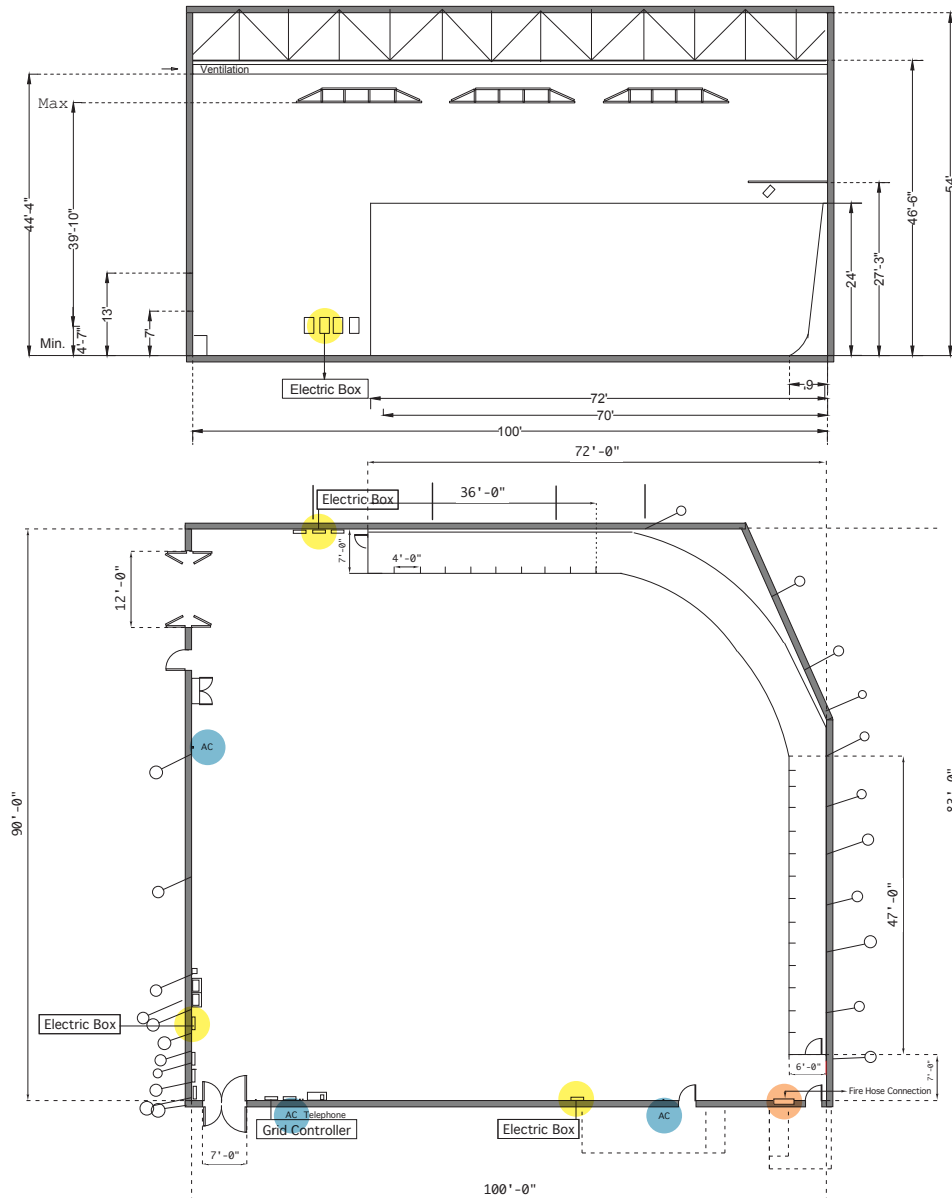

CAPACITY LOAD

MOTHER BEAM

Live Load: **43 lbs/sq ft**
Dead Load: **23 lbs/sq ft**

MOTORIZED GRIDS

650 lbs per suspension
2,600 lbs per 12' x 12' grid

FLOOR

Weight capacity: **125 lbs/sq ft**
Anchor depth max. = **4 in**

ELECTRIC

3 X 200 amp 120 - 208V - 3ØY
Max Capacity: **1,800 amp (100%)**
Continuous demand at **80%**
Periodic demand at **100%**

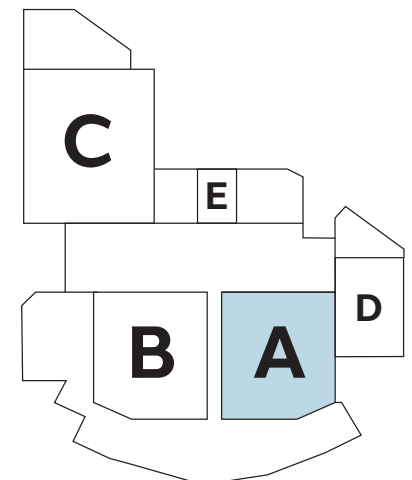

● AC ● FIRE HOSE CONNECTION ● ELECTRIC BOX